

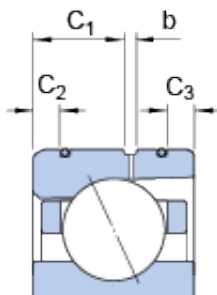

# BEARING CORP.OF AMERICA

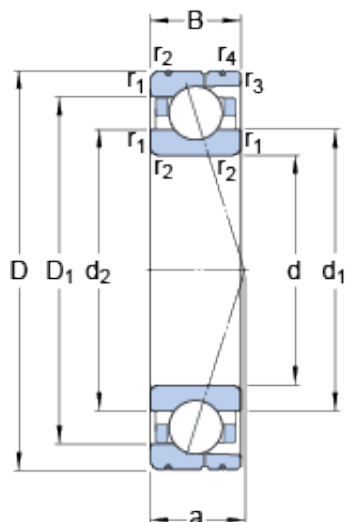

170 mm x 260 mm x 42 mm SKF 7034  
ACD/HCP4AL angular contact ball bearings

Bearing No. 7034 ACD/HCP4AL

7034 ACD/HCP4AL Bearing 2D drawings and 3D CAD models

Size	260x170x42 mm
Bore Diameter	260 mm
Outer Diameter	170 mm
Width	42 mm
d	170 mm
D	260 mm
B	42 mm
d <sub>1</sub>	198.7 mm
d <sub>2</sub>	198.7 mm
D <sub>1</sub>	231.3 mm
b	2.8 mm
C <sub>1</sub>	23.8 mm
C <sub>2</sub>	7.1 mm
C <sub>3</sub>	7.1 mm
r <sub>1,2</sub> - min.	2.1 mm
r <sub>3,4</sub> - min.	1.1 mm
a	71.4 mm
d <sub>a</sub> - min.	181 mm
d <sub>b</sub> - min.	181 mm
D <sub>a</sub> - max.	249 mm
D <sub>b</sub> - max.	254 mm
r <sub>a</sub> - max.	2 mm
r <sub>b</sub> - max.	1 mm
d <sub>n</sub>	205.8 mm



## BEARING CORP.OF AMERICA

Basic dynamic load rating - C	199 kN
Basic static load rating - C <sub>0</sub>	232 kN
Fatigue load limit - P <sub>u</sub>	6.7 kN
Limiting speed for grease lubrication	6000 r/min
Limiting speed for oil lubrication	9000 mm/min
Ball - D <sub>w</sub>	26.988 mm
Ball - z	22
G <sub>ref</sub>	84 cm <sup>3</sup>
Calculation factor - e	0.68
Calculation factor - Y <sub>2</sub>	0.87
Calculation factor - Y <sub>0</sub>	0.38
Calculation factor - X <sub>2</sub>	0.41
Calculation factor - Y <sub>1</sub>	0.92
Calculation factor - Y <sub>2</sub>	1.41
Calculation factor - Y <sub>0</sub>	0.76
Calculation factor - X <sub>2</sub>	0.67
Preload class A - G <sub>A</sub>	1250 N
Preload class B - G <sub>B</sub>	2500 N
Preload class C - G <sub>C</sub>	5000 N
Preload class D - G <sub>D</sub>	10000 N
Calculation factor - f	1.14
Calculation factor - f <sub>1</sub>	0.99
Calculation factor - f <sub>2A</sub>	1
Calculation factor - f <sub>2B</sub>	1.02
Calculation factor - f <sub>2C</sub>	1.05
Calculation factor - f <sub>2D</sub>	1.08
Calculation factor - f <sub>HC</sub>	1.02



## BEARING CORP.OF AMERICA

Preload class A	480 N/micron
Preload class B	625 N/micron
Preload class C	826 N/micron
Preload class D	1113 N/micron
$d_1$	198.7 mm
$d_2$	198.7 mm
$D_1$	231.3 mm
$C_1$	23.8 mm
$C_2$	7.1 mm
$C_3$	7.1 mm
$r_{1,2}$ min.	2.1 mm
$r_{3,4}$ min.	1.1 mm
$d_a$ min.	181 mm
$d_b$ min.	181 mm
$D_a$ max.	249 mm
$D_b$ max.	254 mm
$r_a$ max.	2 mm
$r_b$ max.	1 mm
$d_n$	205.8 mm
Basic dynamic load rating C	199 kN
Basic static load rating $C_0$	232 kN
Fatigue load limit $P_u$	6.7 kN
Attainable speed for grease lubrication	6000 r/min
Attainable speed for oil-air lubrication	9000 r/min
Ball diameter $D_w$	26.988 mm
Number of balls z	22
Reference grease quantity $G_{ref}$	84 cm <sup>3</sup>
Preload class A $G_A$	1250 N
Static axial stiffness, preload class A	480 N/ $\mu$ m



## BEARING CORP.OF AMERICA

Preload class B $G_B$	2500 N
Static axial stiffness, preload class B	625 N/ $\mu$ m
Preload class C $G_C$	5000 N
Static axial stiffness, preload class C	826 N/ $\mu$ m
Preload class D $G_D$	10000 N
Static axial stiffness, preload class D	1113 N/ $\mu$ m
Calculation factor f	1.14
Calculation factor $f_1$	0.99
Calculation factor $f_{2A}$	1
Calculation factor $f_{2B}$	1.02
Calculation factor $f_{2C}$	1.05
Calculation factor $f_{2D}$	1.08
Calculation factor $f_{HC}$	1.02
Calculation factor e	0.68
Calculation factor (single, tandem) $Y_2$	0.87
Calculation factor (single, tandem) $Y_0$	0.38
Calculation factor (single, tandem) $X_2$	0.41
Calculation factor (back-to-back, face-to-face) $Y_1$	0.92
Calculation factor (back-to-back, face-to-face) $Y_2$	1.41
Calculation factor (back-to-back, face-to-face) $Y_0$	0.76
Calculation factor (back-to-back, face-to-face) $X_2$	0.67
Mass bearing	5.92 kg