

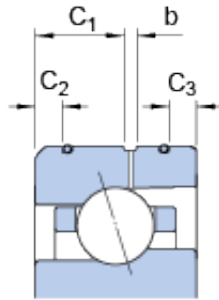

BEARING CORP.OF AMERICA

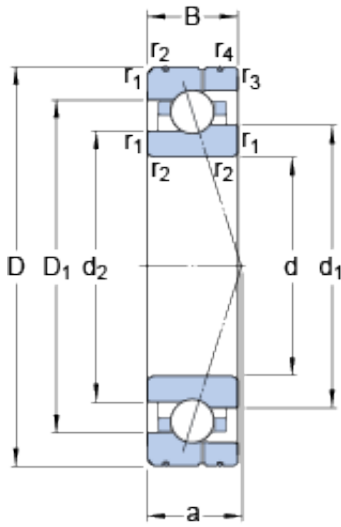

55 mm x 90 mm x 18 mm SKF 7011 CE/P4AL
angular contact ball bearings

Bearing No. 7011 CE/P4AL

7011 CE/P4AL Bearing 2D drawings and 3D CAD models

Size	90x55x18 mm
Bore Diameter	90 mm
Outer Diameter	55 mm
Width	18 mm
d	55 mm
D	90 mm
B	18 mm
d ₁	67.73 mm
d ₂	65.6 mm
D ₁	77.25 mm
b	2.4 mm
C ₁	9 mm
C ₂	3.4 mm
C ₃	3.4 mm
r _{1,2} - min.	1.1 mm
r _{3,4} - min.	0.6 mm
a	18.8 mm
d _a - min.	61 mm
d _b - min.	61 mm
D _a - max.	84 mm
D _b - max.	85.8 mm
r _a - max.	1 mm
r _b - max.	0.6 mm
d _n	69.6 mm



BEARING CORP.OF AMERICA

Basic dynamic load rating - C	16.8 kN
Basic static load rating - C ₀	12.2 kN
Fatigue load limit - P _u	0.52 kN
Limiting speed for grease lubrication	22000 r/min
Limiting speed for oil lubrication	34000 mm/min
Ball - D _w	7.938 mm
Ball - z	24
G _{ref}	5 cm ³
Calculation factor - f ₀	8.4
Preload class A - G _A	90 N
Preload class B - G _B	270 N
Preload class C - G _C	540 N
Calculation factor - f	1.07
Calculation factor - f	1
Calculation factor - f _{2A}	1
Calculation factor - f _{2B}	1.03
Calculation factor - f _{2C}	1.05
Calculation factor - f _{HC}	1
Preload class A	46 N/micron
Preload class B	72 N/micron
Preload class C	98 N/micron
d ₁	67.73 mm
d ₂	65.6 mm
D ₁	77.25 mm
C ₁	9 mm
C ₂	3.4 mm
C ₃	3.4 mm
r _{1,2} min.	1.1 mm



BEARING CORP.OF AMERICA

$r_{3,4}$ min.	0.6 mm
d_a min.	61 mm
d_b min.	61 mm
D_a max.	84 mm
D_b max.	85.8 mm
r_a max.	1 mm
r_b max.	0.6 mm
d_n	69.6 mm
Basic dynamic load rating C	16.8 kN
Basic static load rating C_0	12.2 kN
Fatigue load limit P_u	0.52 kN
Attainable speed for grease lubrication	22000 r/min
Attainable speed for oil-air lubrication	34000 r/min
Ball diameter D_w	7.938 mm
Number of balls z	24
Reference grease quantity G_{ref}	5 cm ³
Preload class A G_A	90 N
Static axial stiffness, preload class A	46 N/ μ m
Preload class B G_B	270 N
Static axial stiffness, preload class B	72 N/ μ m
Preload class C G_C	540 N
Static axial stiffness, preload class C	98 N/ μ m
Calculation factor f	1.07
Calculation factor f_1	1
Calculation factor f_{2A}	1
Calculation factor f_{2B}	1.03
Calculation factor f_{2C}	1.05
Calculation factor f_{HC}	1



BEARING CORP.OF AMERICA

Calculation factor f_0	8.4
Mass bearing	0.39 kg